

A66 Northern Trans-Pennine Project

Scheme 11: A1(M) Junction 53 Scotch Corner

TR010062

5.19 Rights of Way and Access Plans

APFP Regulations 5(2)(k) and 5(2)(o)

Planning Act 2008

**Infrastructure Planning (Applications: Prescribed Forms and
Procedure) Regulations 2009**

June 2022

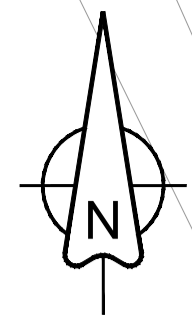
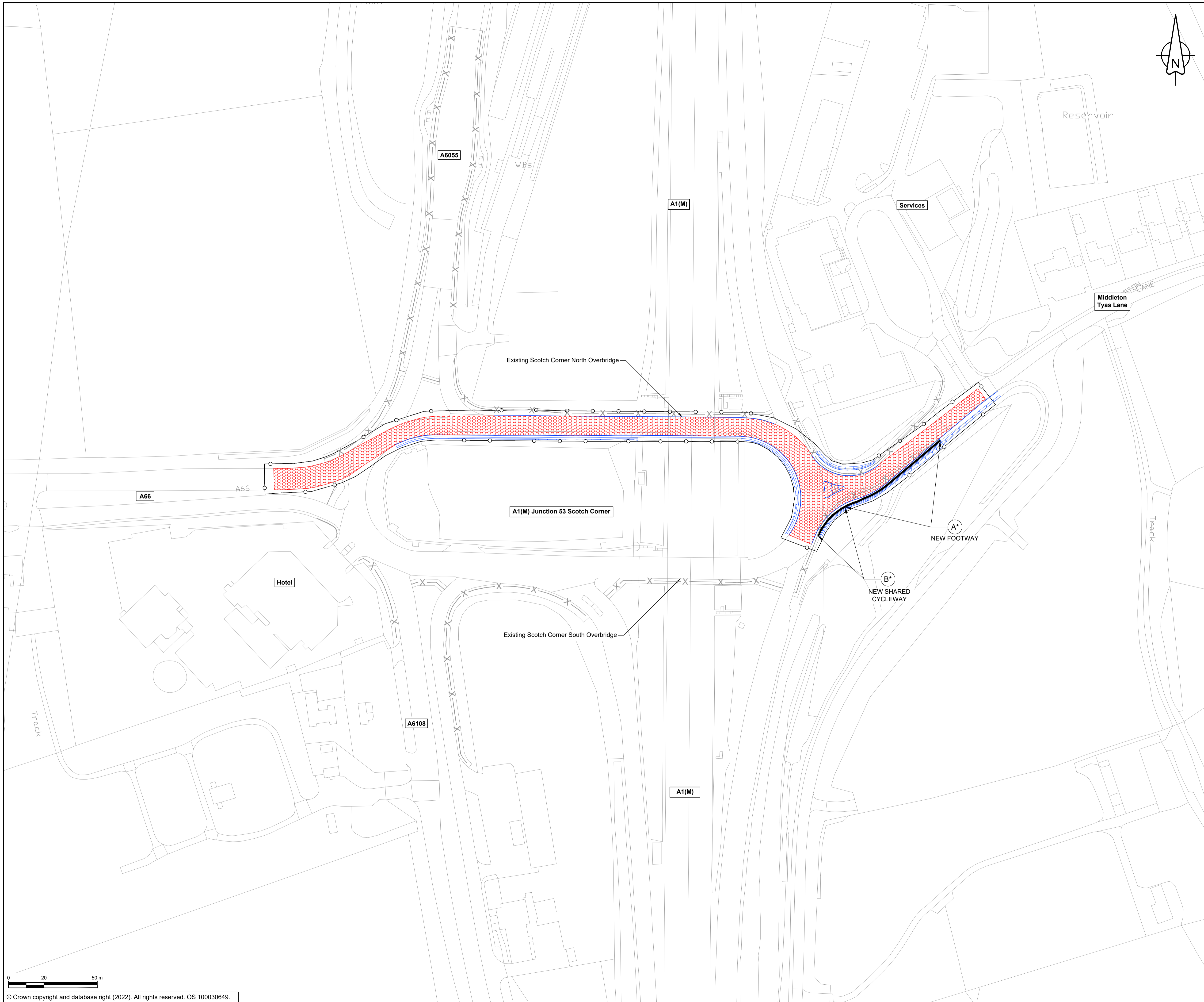

- NOTES**
- ALL DIMENSIONS ARE IN METRES UNLESS NOTED OTHERWISE.
 - THESE PLANS ARE TO BE READ IN CONJUNCTION WITH THE SCHEDULE ENTITLED "PERMANENT STOPPING UP OF HIGHWAYS AND PRIVATE MEANS OF ACCESS" TO THE DEVELOPMENT CONSENT ORDER.
- KEY**
- THE SCHEME (SHOWN FOR ILLUSTRATIVE PURPOSES ONLY)
 - EXISTING HIGHWAY TO BE STOPPED UP
 - NEW OR IMPROVED HIGHWAY - TRUNK ROAD
 - NEW PUBLIC RIGHT OF WAY AND NEW PRIVATE MEANS OF ACCESS
 - NEW PUBLIC RIGHT OF WAY
 - NEW PRIVATE MEANS OF ACCESS
 - NEW OR IMPROVED SIDE ROAD
 - PRIVATE MEANS OF ACCESS TO BE STOPPED UP
 - PROPOSED SIDE ROAD / NEW PUBLIC RIGHT OF WAY BOUNDARY
 - PROPOSED TRUNK ROAD BOUNDARY
 - EXISTING PUBLIC RIGHT OF WAY
 - PARISH BOUNDARY
 - PRIVATE MEANS OF ACCESS TO BE STOPPED UP REFERENCE LABEL
 - NEW PRIVATE MEANS OF ACCESS REFERENCE LABEL
 - NEW PUBLIC RIGHT OF WAY AND SIDE ROADS REFERENCE LABEL
 - NEW WALKING AND/OR CYCLING AND/OR HORSE RIDING PROVISION (AS SPECIFIED ON PLAN AND IN SCHEDULE)
 - CHAINAGE (MEASURED DISTANCE ALONG THE SCHEME LENGTH)

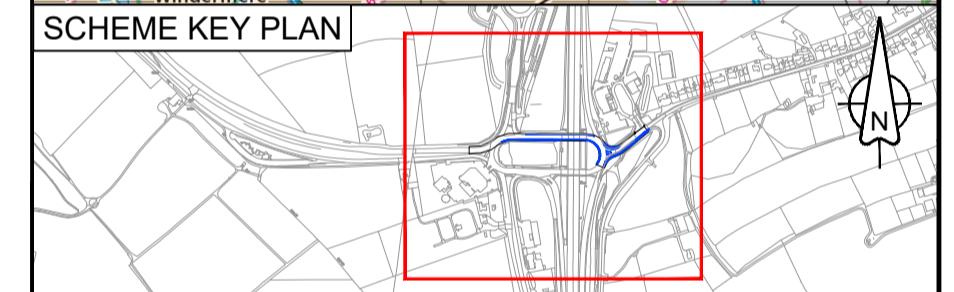
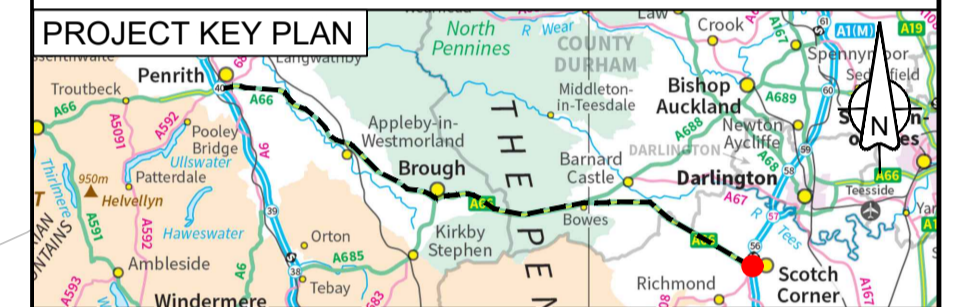

C01	For DCO Submission				
	RKIG	RKIG	EKEL	TEGG	SSCO
	07/06/22	07/06/22	07/06/22	07/06/22	07/06/22
Revision details					
Revision	Created	Checked	Reviewed	Approved	Authorised
	dd/mm/yy	dd/mm/yy	dd/mm/yy	dd/mm/yy	dd/mm/yy

Purpose
DCO APPLICATION

PINS Reference Number
TR010062/APP/5.19

Client
3 Piccadilly Place
Manchester
M1 3BN



Project Name / Scheme Name
A66 Northern Trans-Pennine Project
Scheme 11
A1(M) Junction 53 Scotch Corner

Drawing Title
Rights of Way & Access Plans
Regulation 5(2)(k) & 5(2)(o)
Sheet 1 of 1

Project Ref. No.	Stage	Scale :	@ A1
---	PCF3	1:1000	
		Dimensions :	M

Drawing Number	Project	Originator	Volume
HE565627	- AMY	- HAC	-
S11	-DR-CH-	901401	
Location	Type	Role	Number

Suitability	Suitability Description	Revision
A	Approved for Stage Complete	C01